

VICINITY MAP

# LITTLE TONSINA TRIBUTARY- ATV CROSSING FISH PASSAGE IMPROVEMENT PROJECT

DRAWING INDEX	
SHEET NO.	TITLE
G-001	TITLE SHEET
G-002	QUANTITIES & GENERAL NOTES
V-001	SURVEY
C-101	SITE PLAN
C-102	CROSSING PLAN AND PROFILE
C-201	ATV TRAIL PLAN AND PROFILE
C-501	CROSS SECTION DETAILS



ITEM NO.	DESCRIPTION	UNIT	QUANTITY
201.0009.0000	Clearing and Grubbing	LS	0.07
202.0004.0000	Removal of Culvert Pipe	LF	52
203.0003.0000	Unclassified Excavation	CY	245
TBD	Abutment Material	CY	37
521.TBD	Structure- 48' long by 8' wide ATV Bridge	LS	1
TBD	2'x8' Bridge decking- pressure-treated wood	EA	30
TBD	Stream Substrate	CY	74
611.0001.0002	Riprap, Class II	CY	185
618.0002.000B	Seeding, Type B	LB	5
620.0001.0000	Topsoil	SY	136
640.0001.0000	Mobilization & Demobilization	LS	All Req'd
641.0005.0000	Temporary Erosion and Pollution Control	LS	All Req'd
642.0001.0000	Construction Surveying	LS	All Req'd
690.TBD	Live Willow Staking	LF	280
690.0002.0000	Vegetative Mat Salvage and Replanting	SY	94
690.TBD	Salvaged Vegetation and Slash	SY	529
690.TBD	Rootwads	LF	20
691.0001.0000	Stream Diversion and Dewatering	LS	All Req'd

GENERAL NOTES:

- THE CONTRACTOR IS RESPONSIBLE FOR VERIFYING THE EXACT LOCATION OF ALL SITE FEATURES. IF CONDITIONS OTHER THAN THOSE SHOWN ON THE PLANS ARE ENCOUNTERED, THE CONTRACTOR SHALL IMMEDIATELY NOTIFY THE OWNER.
- PLANS MAY NOT SHOW ALL EXISTING UTILITIES. THE CONTRACTOR IS RESPONSIBLE FOR LOCATING ALL EXISTING UTILITIES PRIOR TO CONSTRUCTION
- EXERCISE EXTREME CAUTION AND OBSERVE ALL APPLICABLE OSHA REQUIREMENTS FOR WORKING IN CONFINED AREAS AND OPEN EXCAVATIONS.
- EXCAVATION AND BACKFILL: REMOVE ALL ORGANIC OR OVER SATURATED SOFT MATERIAL WHICH CANNOT BE COMPACTED.
- VERIFY TIE-IN ELEVATIONS OF CHANNEL PRIOR TO CONSTRUCTION. REPORT ANY DISCREPANCIES FROM PLANS IMMEDIATELY TO OWNER'S REPRESENTATIVE.
- ALL VEGETATION IN AREAS NOT AFFECTED BY WORK SHALL BE PRESERVED AND PROTECTED BY THE CONTRACTOR. RESEED ALL DISTURBED AREAS IN CONFORMANCE WITH REVEGETATION PLAN ON SHEET L-101.
- ALL DIMENSIONS ARE IN DECIMAL FEET UNLESS NOTED OTHERWISE.

ABBREVIATIONS	
ALBC	ALUMINUM BOX CULVERT
BMP	BEST MANAGEMENT PRACTICE
CFS	CUBIC FEET PER SECOND
CSP	CORRUGATED STEEL PIPE
CY	CUBIC YARDS
E	EASTING
EA	EACH
ELEV	ELEVATION
FT	FEET
GALV	GALVANIZED
IE	INVERT ELEVATION
IN	INCH
LF	LINEAL FEET
LS	LUMP SUM
MIN	MINIMUM
N	NORTHING
NTS	NOT TO SCALE
O.F.	OVER FLOW
OHW	ORDINARY HIGH WATER
PSF	POUNDS PER SQUARE FOOT
Q	FLOW
ROW	RIGHT OF WAY
STA	STATION
SY	SQUARE YARDS
TYP	TYPICAL

LEGEND

STREAM SUBSTRATE

VEGETATIVE MAT

LIMIT OF DISTURBANCE

PERIMETER CONTROL

ORDINARY HIGH WATER MARK

THALWEG

FINISHED GRADE .5' CONTOUR LINES

FINISHED GRADE 2.5' CONTOUR LINES

EXISTING GRADE .5' CONTOUR LINES

EXISTING GRADE 2.5' CONTOUR LINES

NOTES:

1. FIELD SURVEY IS UNOFFICIAL, UNLICENSED, AND ALL ELEVATIONS ARE RELATIVE. NO BASIS OF COORDINATES OR ELEVATIONS EXISTS.

CALL BEFORE YOU DIG

CONTRACTOR SHALL CONTACT  
UTILITY COMPANIES TWO WEEKS  
PRIOR TO EXCAVATION.

ALASKA DIG LINE: 1-800-478-3121  
WWW.AKONECALL.COM

POINT TABLE				
POINT #	NORTHING	EASTING	ELEVATION	DESCRIPTION
526	2773911.829	1776196.035	98.54	tbm 1 – stake in tree
527	2773911.721	1776142.228	102.95	tbm 2 – stake in tree
528	2773890.958	1776137.215	101.00	tbm 3 – stake in tree

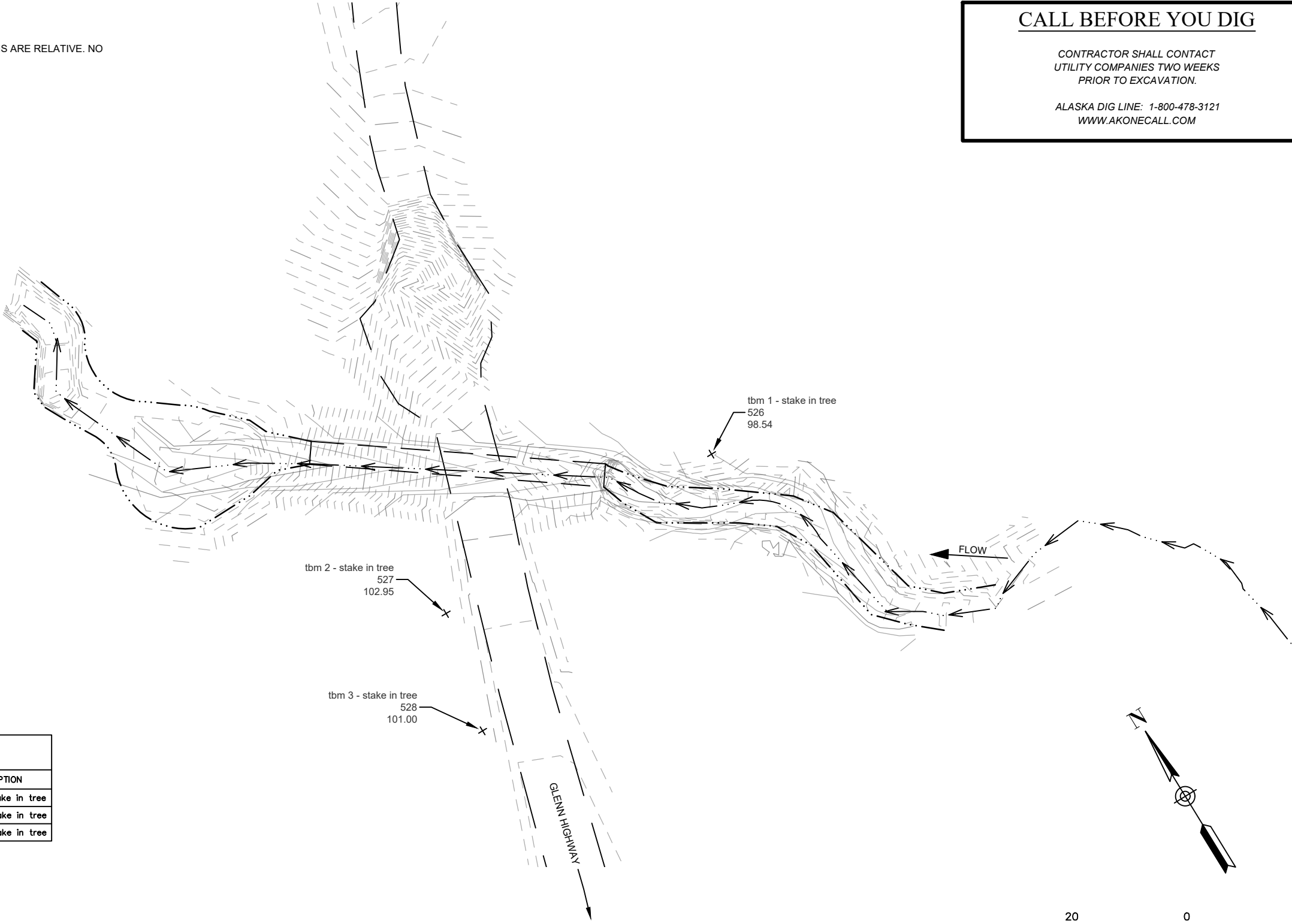

PLAN VIEW



U.S. FISH AND WILDLIFE SERVICE  
ANCHORAGE CONSERVATION OFFICE  
4700 BLM ROAD  
ANCHORAGE, AK 99507  
907-271-2888

Revision No.	Description	Date
Project Partners:		
CRWP, BLM		

Designed J.STRAUB
Drawn J.STRAUB
Checked K.VALENTINE
Date 2/6/24

Project Title:  
FP IMPROVEMENT PROJECT

Project Location:  
LITTLE TONSINA TRIBUTARY

SURVEY

SHEET NUMBER:

V-001





INLET VIEW, LOOKING DOWNSTREAM



WASHOUT VIEW, LOOKING UPSTREAM



OUTLET VIEW, LOOKING UPSTREAM

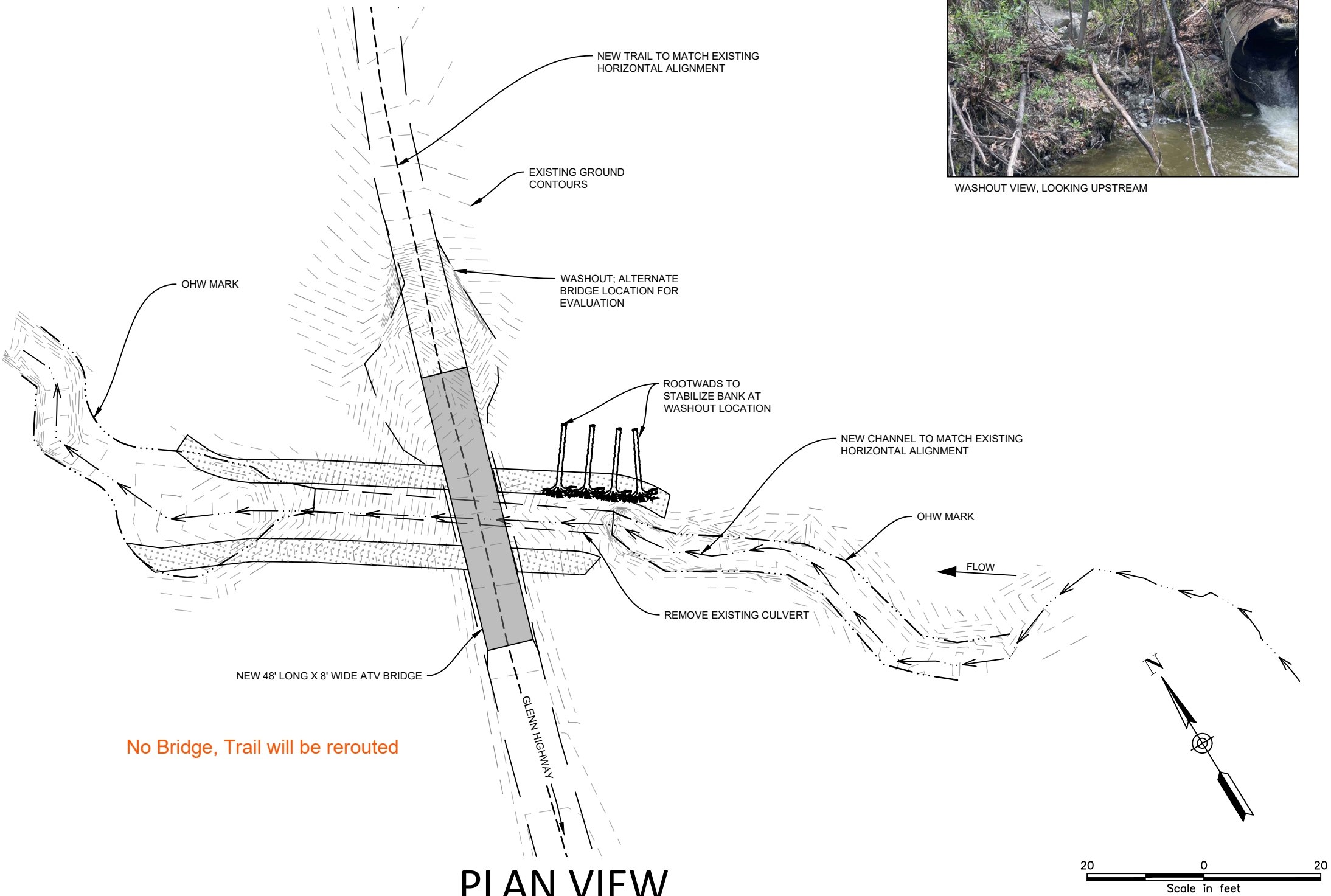

PLAN VIEW



U.S. FISH AND WILDLIFE SERVICE  
ANCHORAGE CONSERVATION OFFICE  
4700 BLM ROAD  
ANCHORAGE, AK 99507  
907-271-2888

Revision No.	Description	Date	Designed J.STRAUB
			Drawn J.STRAUB
			Checked K. VALENTINE
			Date 2/6/24
Project Partners: CRWP, BLM			

Project Title:  
FP IMPROVEMENT PROJECT

Project Location:  
LITTLE TONSINA TRIBUTARY

SITE PLAN

SHEET NUMBER:  
C-101

POINT TABLE				
POINT #	NORTHING	EASTING	ELEVATION	DESCRIPTION
536	2773957.719	1776113.254	84.79	TIE IN
1313	2773861.142	1776252.910	92.75	TIE IN

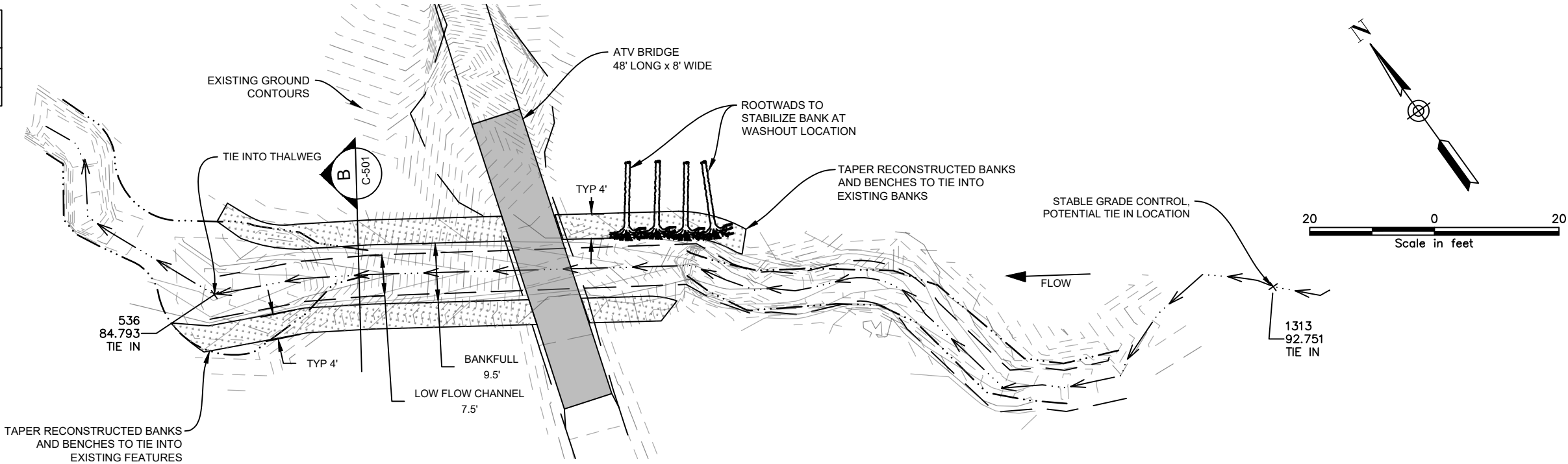

PLAN VIEW

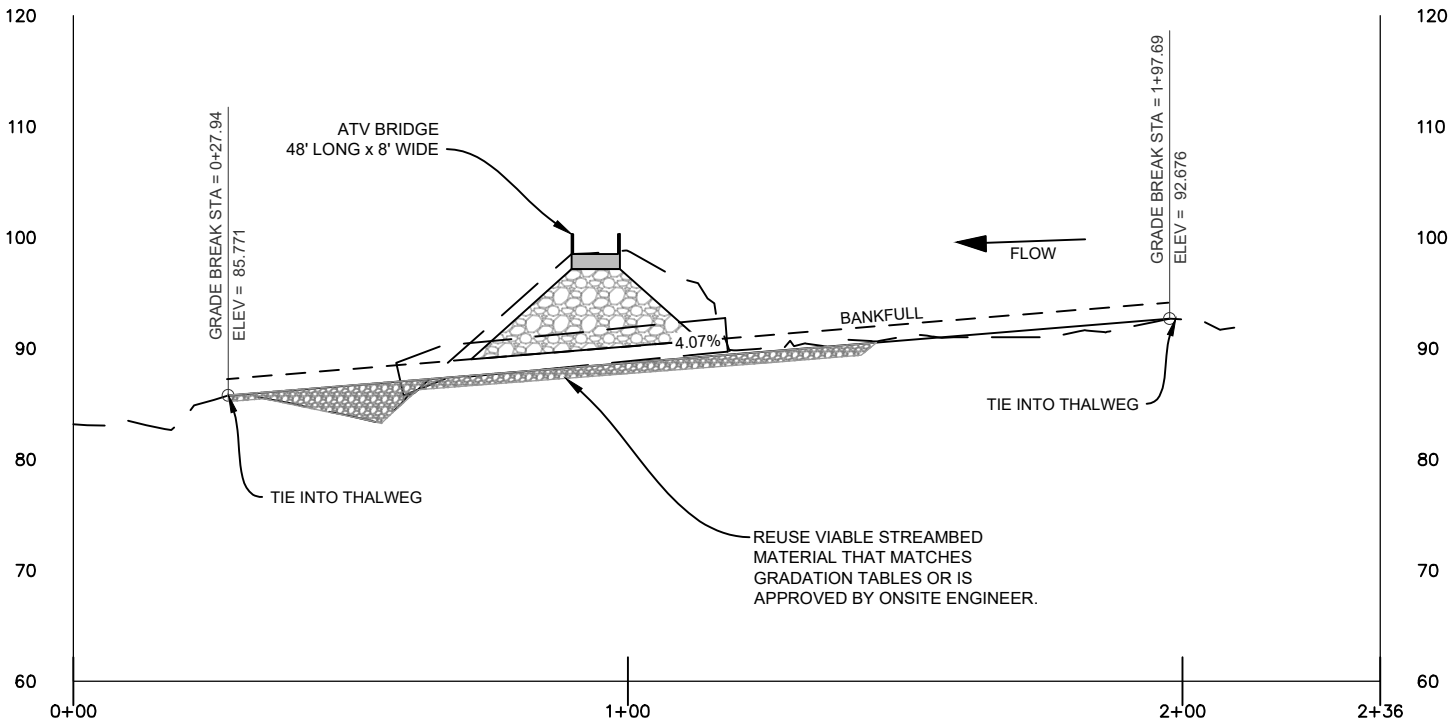

PROFILE VIEW

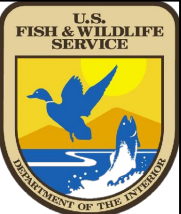

U.S. FISH AND WILDLIFE SERVICE  
ANCHORAGE CONSERVATION OFFICE  
4700 BLM ROAD  
ANCHORAGE, AK 99507  
907-271-2888

Revision No.	Description	Date
Project Partners:		
CRWP, BLM		
Designed	J.STRAUB	
Drawn	J.STRAIN	
Checked	K. VALENTINE	
Date	2/6/24	

Project Title:	FP IMPROVEMENT PROJECT
Project Location:	LITTLE TONSINA TRIBUTARY

CROSSING PLAN AND  
PROFILE

SHEET NUMBER:  
**C-102**



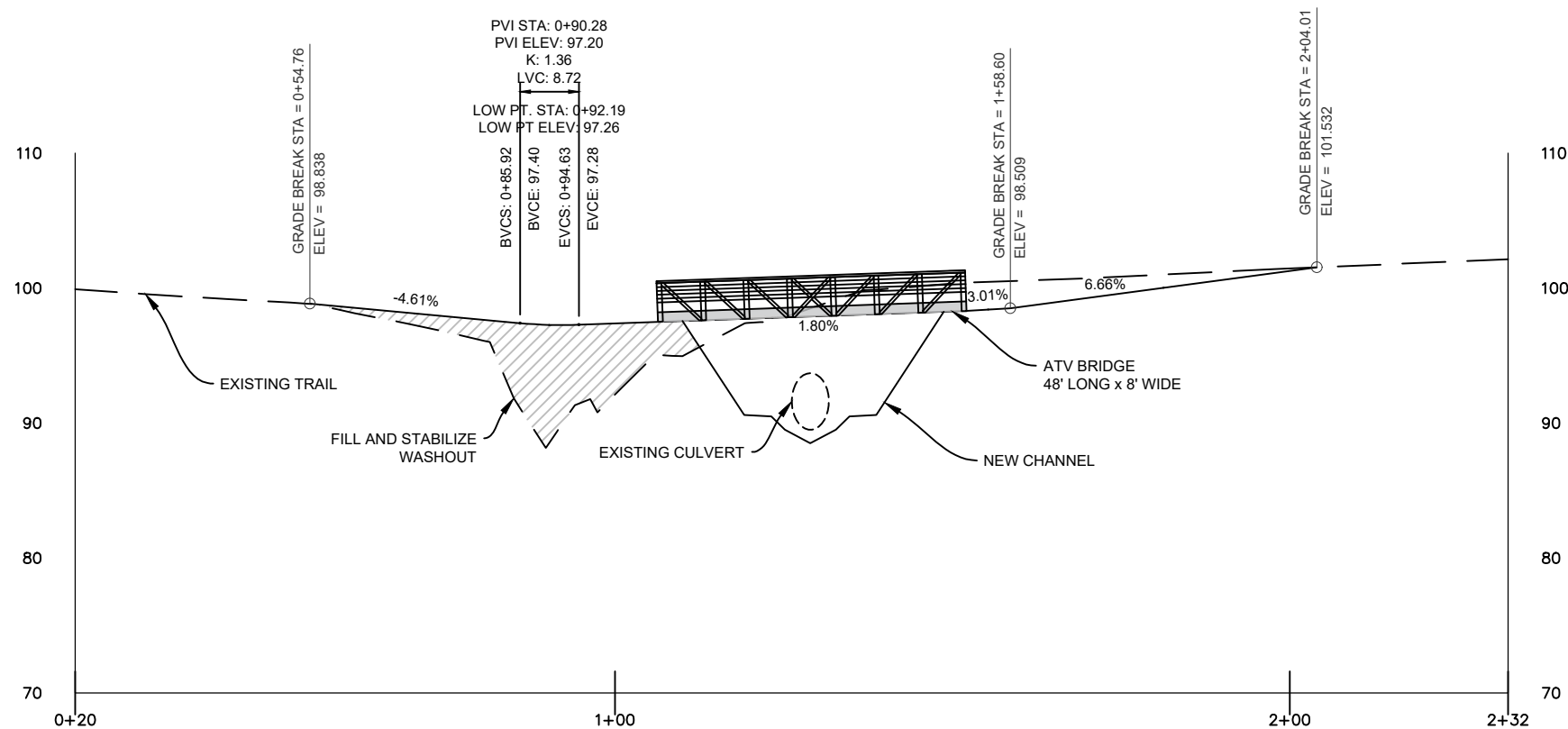
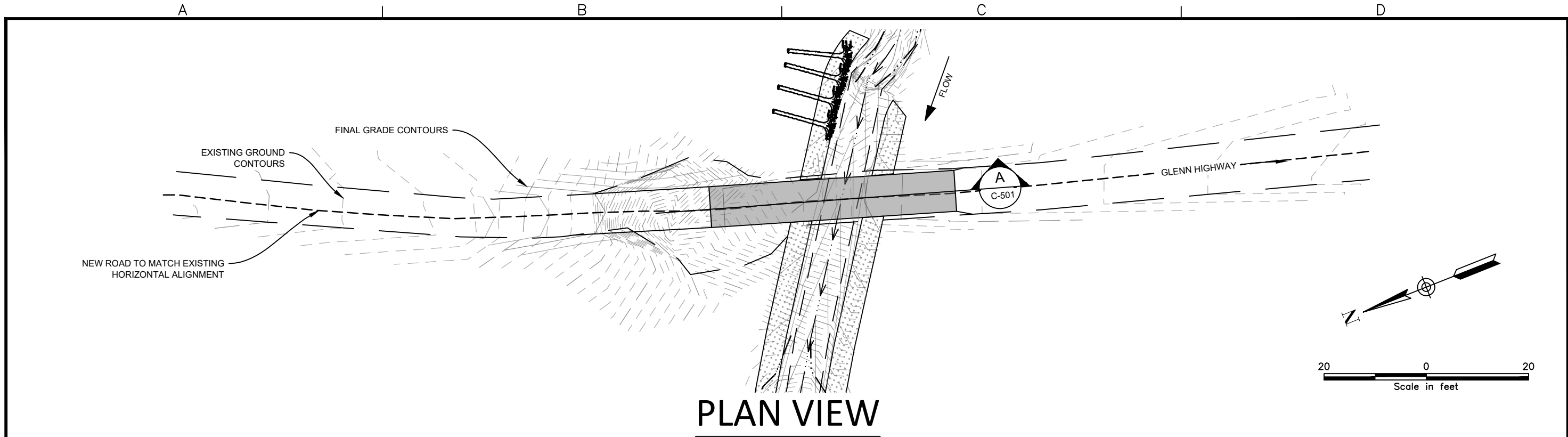

	U.S. FISH AND WILDLIFE SERVICE ANCHORAGE CONSERVATION OFFICE 4700 BLM ROAD ANCHORAGE, AK 99507 907-271-2888	Revision No.	Description	Date	Designed J.STRAUB	Project Title: FP IMPROVEMENT PROJECT	ATV TRAIL PLAN AND PROFILE	SHEET NUMBER:  C-201
					Drawn J.STRAUB			
					Checked K.VALENTINE			
		Project Partners:			Date 2/6/24			
		CRWP, BLM						
						Project Location: LITTLE TONSINA TRIBUTARY		

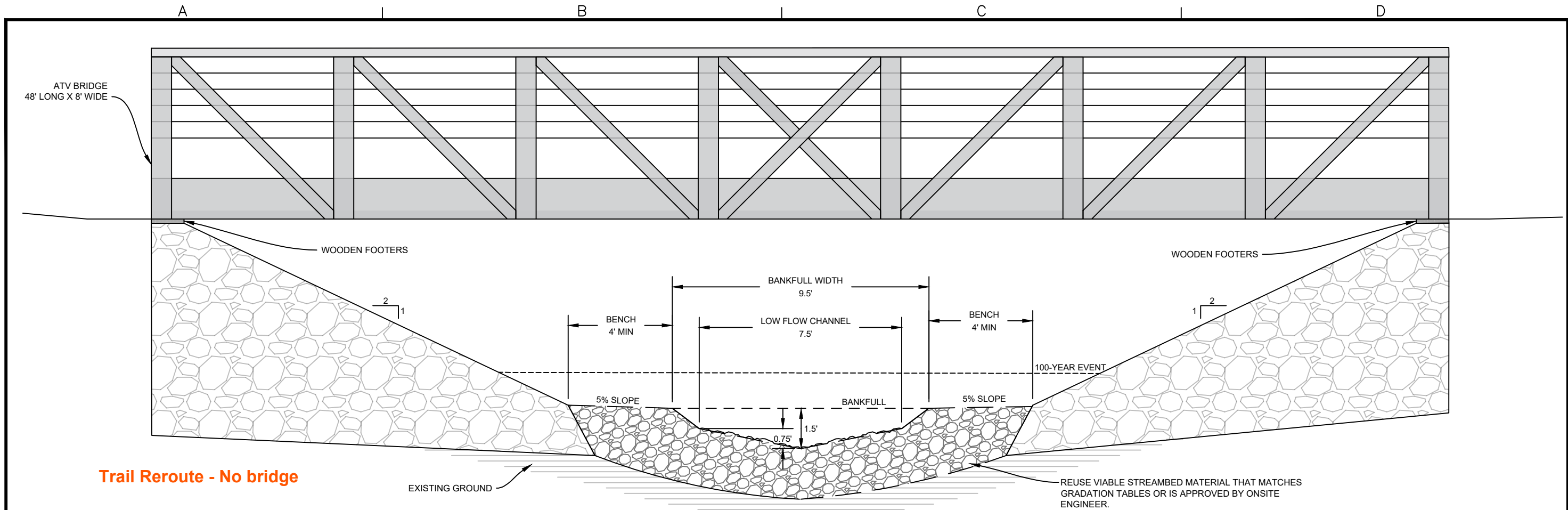

Trail Reroute - No bridge

## SECTION A: CROSSING CROSS SECTION VIEW

NOT TO SCALE

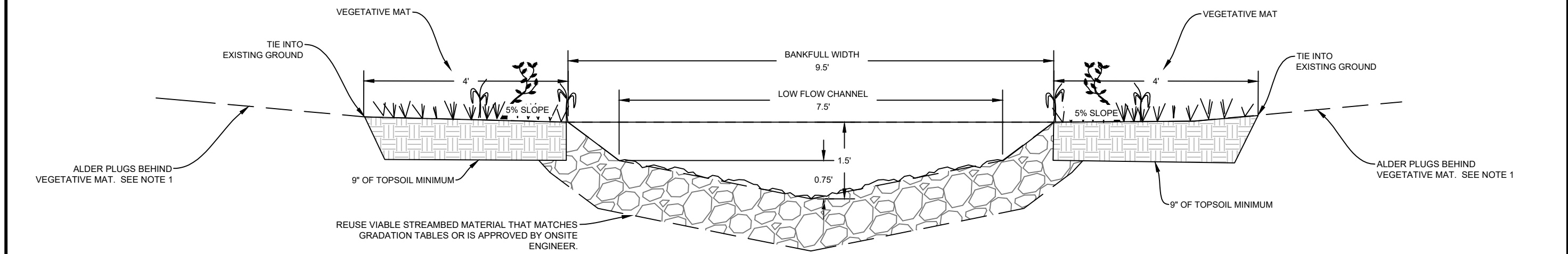

## SECTION B: CHANNEL CROSS SECTION VIEW

NOT TO SCALE

NOTES:  
1. INSTALL IN ACCORDANCE WITH THE ALASKA DEPARTMENT OF FISH AND GAME STREAMBANK RESTORATION GUIDE.  
<https://www.adfg.alaska.gov/index.cfm?adfg=streambankprotection.main>.

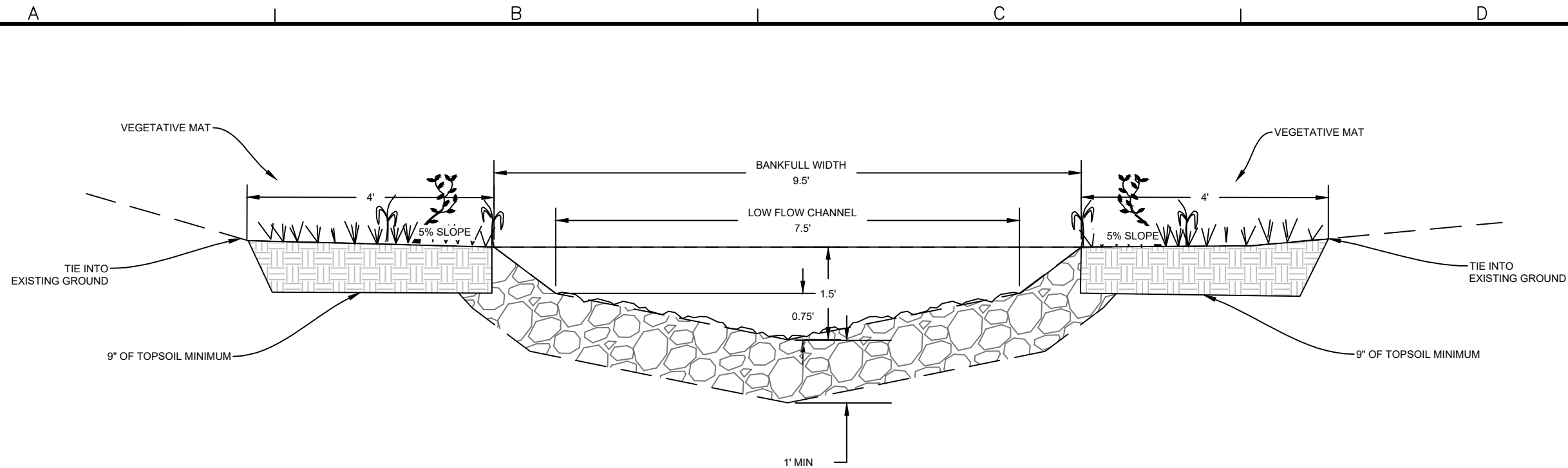

SECTION B: CHANNEL CROSS SECTION VIEW

NOT TO SCALE



U.S. FISH AND WILDLIFE SERVICE  
ANCHORAGE CONSERVATION OFFICE  
4700 BLM ROAD  
ANCHORAGE, AK 99507  
907-271-2888

Revision No.	Description	Date
Project Partners:		
CRWP, BLM		
Designed	J.STRAUB	
Drawn	J.STRAUB	
Checked	K.VALENTINE	
Date	2/6/24	

Project Title:	FP IMPROVEMENT PROJECT
Project Location:	LITTLE TONSINA TRIBUTARY

CHANNEL SECTION  
AND DETAILS

SHEET NUMBER:
C-502